

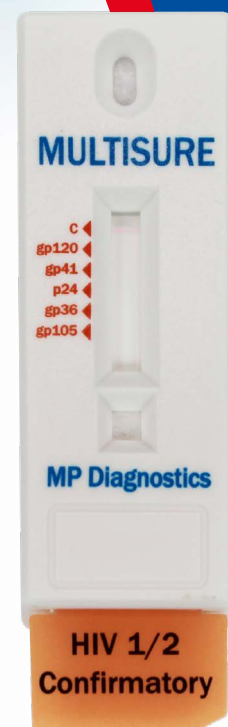

# MULTISURE® HIV 1/2 Confirmatory Test

**SOLUTION TO CONFIRMATORY TEST IN <30  
MINUTES...**

- ▶ Confirm and Differentiate HIV-1 and HIV-2
- ▶ Accurate Result
- ▶ Simple Workflow
- ▶ Flexible: Manual or Automatic Reading of Result
- ▶ Wide Temperature Storage (2 °C–30 °C)



# YOUR PARTNER IN DIAGNOSTICS

MP Biomedicals is a leading global corporation with a long-standing history of manufacturing high-quality diagnostic products, including Immunoblot, ELISA, RIA, and Point-of-Care Testing (POCT) products. As the global market leader in the field, we endeavor to raise the bar for HIV testing.

MULTISURE® HIV 1/2 Confirmatory Test is intended as a rapid confirmatory test, developed to detect and differentiate antibodies specific to HIV-1 gp120, HIV-1 gp41, HIV-1 p24 and HIV-2 gp36, HIV-2 gp105 antigens in human serum or plasma.

## Qualitative immuno-chromatographic assay

For the rapid in-vitro detection and differentiation of antibodies to Human Immunodeficiency Virus Type 1 and 2 in human serum or plasma.

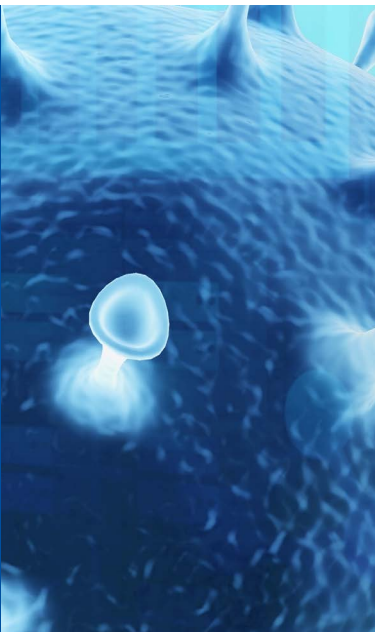



**Human Serum or Plasma**



**Flexible: Manual or Automatic Reading**



**Wide Temperature Storage (2-30°C)**

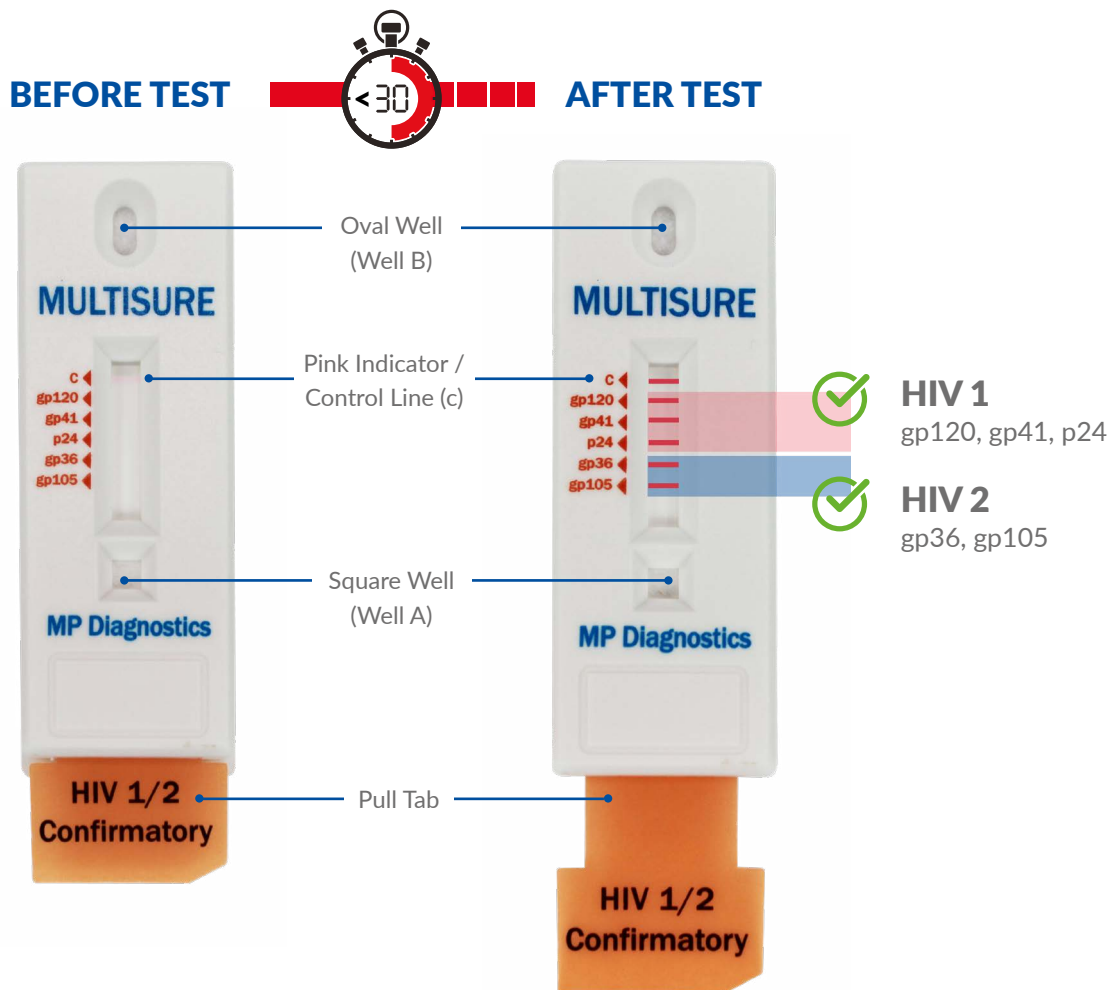

Example of test device with all visible test lines



## TOTAL DIAGNOSTIC PERFORMANCE

Diagnostic Parameter	Performance of MP Diagnostics MULTISURE® HIV 1/2 Confirmatory Test	95% Confidence Interval
Diagnostic Sensitivity	100.00% (396/396)	99.1% to 100.0%
Diagnostic Specificity	98.3% (510/519) (9 Indeterminate for HIV Antibody)	96.7% to 99.2%
Positive Predictive Value	97.8%	95.8% to 98.8%
Negative Predictive Value	100.00%	NA

## CLINICAL PERFORMANCE

Diagnostic Parameter	Sample Profile	Total Sample Size (n)	Performance of MP Diagnostics MULTISURE® HIV 1/2 Confirmatory Test
Diagnostic Sensitivity	HIV-1 Seropositive	50	100% (50/50)
	HIV-2 Seropositive	26	92.3% (24/26) (2 Indeterminate for HIV antibody)
	Total	76	97.4% (74/76) (2 Indeterminate for HIV antibody)
Diagnostic Specificity	HIV-Negative	50	100% (50/50)

# SIMPLE ASSAY PROCEDURE

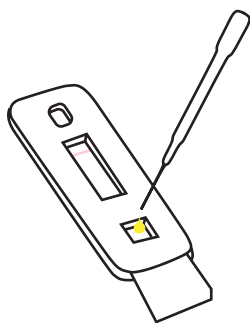

- Add **25 µL sample** into the square well

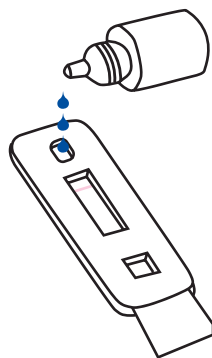

- When sample front reaches the pink indicator line, add **3 drops of chase buffer** into the oval well.
- Do not allow sample front to flow out of test viewing window.

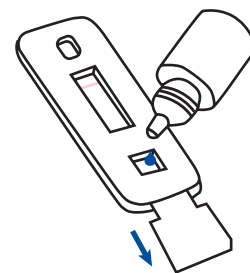

Pull the HIV tab until resistance is felt.

- Add **1 drop of chase buffer** into the square well.
- Start the timer.
- Read result at **25 mins**.
- Do not read result after 35 mins.



Scan the QR code to watch the detailed instructional video

## ENHANCED ASSURANCE

Monitor the performance of MULTISURE® HIV 1/2 Confirmatory Test with **MULTISURE® HIV 1/2 Confirmatory Test Controls**



# YOUR OPTION FOR AUTOMATION

Automate your rapid test workflow with:

- ▶ iPeak® 4.3" Lateral Flow Reader
- ▶ MP Diagnostics Rapid Test - Report Generator Software



## Reduces Error and Variability

Automatic reader enables accurate results



## Robust & User-Friendly

Minimal training required, read your test at any moment



## Simplifies Data Management & Archiving

Dedicated report generator software

The iPeak® reader 4.3" Lateral Flow Reader provides qualitative in-vitro measurement of immunochromatographic test. Both iPeak® 4.3" Lateral Flow Reader and MP Diagnostics Rapid Test Report Generator software have been validated on the following test devices:

- ▶ MULTISURE HIV 1/2 Confirmatory Test
- ▶ MULTISURE HCV Antibody Assay
- ▶ MULTISURE HIV Rapid Test
- ▶ ASSURE TB Rapid Test
- ▶ MULTISURE Dengue Ab/Ag Rapid Test
- ▶ ASSURE SARS-CoV-2 IgG/IgM Rapid Test
- ▶ ASSURE H. pylori Rapid Test
- ▶ ASSURE HEV IgM Rapid Test



## LEARN MORE

Want to learn more?  
Scan the QR code



# DISCOVER OUR HIV PORTFOLIO

MP Biomedicals offers a complete range of diagnostics products dedicated for HIV detection.

## MULTISURE HIV RAPID TEST (CE)

SKU: 0743030020

The MULTISURE<sup>®</sup> HIV Rapid Test is intended as a rapid diagnostic test, developed to detect antibodies specific to HIV-1 gp120, HIV-1 gp41, HIV-1 p24 (also react with HIV-2) and HIV-2 gp36 antigens in human serum, plasma, finger pricked whole blood or whole blood with anti-coagulants.

- ▶ Excellent Performance: 100% Sensitivity, 99.12% Specificity
- ▶ Detects and Differentiates HIV 1 and 2
- ▶ Patented Reverse Flow Technology
- ▶ CE Marked



**LEARN MORE?**  
Visit our webpage!



## HIV BLOT 2.2 (CE)

SKU: 0711030018 & 0711030036

HIV BLOT 2.2 is a qualitative enzyme immunoassay for the in vitro detection of antibodies to human immunodeficiency virus type 1 (HIV-1) and type 2 (HIV-2) in human serum or plasma. It is intended for use as a more specific supplemental test on human serum or plasma specimens found repeatedly reactive using screening procedures such as ELISA.

- ▶ Gold Standard for HIV-1 and HIV-2 Detection
- ▶ Simple Type: Human Plasma, Human Serum
- ▶ CE Marked



**LEARN MORE?**  
Visit our webpage!



# ORDERING INFORMATION

## ▶ MULTISURE HIV 1/2 CONFIRMATORY TEST

Name	Size	Cat. No.
MULTISURE® HIV 1/2 Confirmatory Test (CE)	20 tests/kit	0793030020
MULTISURE® HIV 1/2 Confirmatory Test Controls (CE)	6 tests/kit	0790030006
iPeak® 4.3" Lateral Flow Reader	1 unit	07EMC045

*\*The Rapid Test Report Generator Software is available for free with the purchase of iPeak® 4.3" Lateral Flow Reader.*

## ▶ MULTISURE HIV & HIV BLOT 2.2

Name	Size	Cat. No.
MULTISURE® HIV Rapid Test (CE)	20 tests/kit	0743030020
HIV Blot 2.2 (CE)	18 tests/kit	0711030018
HIV Blot 2.2 (CE)	36 tests/kit	0711030036

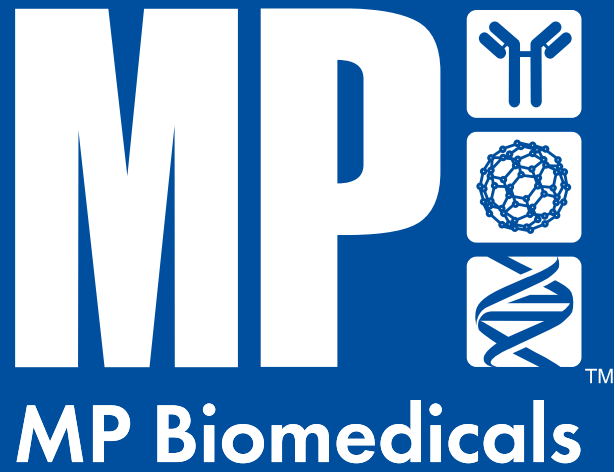

*Need more information on our HIV products?*

**Emailed us!**



**MP BIOMEDICALS**

**EUROPE:** +49 (0) 5651 921 186 | [diagnostics@mpbio.com](mailto:diagnostics@mpbio.com)

**AMERICAS:** 800.854.0530 | [custserv.na@mpbio.com](mailto:custserv.na@mpbio.com)

**APAC:** +65 6775.0008 | [custserv.ap@mpbio.com](mailto:custserv.ap@mpbio.com)



[www.mpbio.com](http://www.mpbio.com)

07930300-BR2202EN